



**Enfields Hythe**  
3 Marsh Parade,  
Hythe, Southampton,  
Hampshire, SO45 6AN  
T 023 8084 9210  
E sales-hythe@enfields.co.uk

Ridley Close, Holbury, Southampton, SO45 2NR

Guide Price £300,000

3 1 1



Great family home situated in a cul-de-sac location close to the New Forest National Park, Lepe Beach and Calshot activity Center.

This house consists of entrance porch, hallway, living room and kitchen on the ground floor.

On the first floor we have the landing, three bedrooms and a family bathroom.

Outside you have the garden to the front and rear with a garage in a nearby block.

Call us now to arrange a viewing.



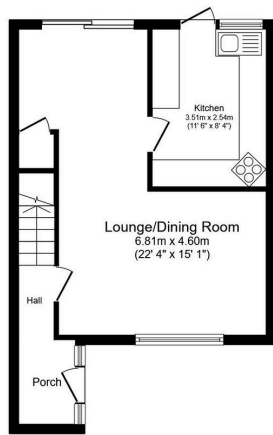

**Ground Floor**  
Floor area 40.0 m<sup>2</sup> (430 sq.ft.)

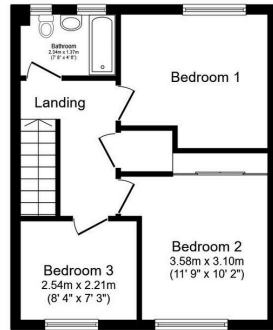

**First Floor**  
Floor area 37.5 m<sup>2</sup> (403 sq.ft.)

TOTAL: 77.5 m<sup>2</sup> (834 sq.ft.)

This floor plan is for illustrative purposes only. It is not drawn to scale. Any measurements, floor areas (including any total floor area), openings and orientations are approximate. No details are guaranteed, they cannot be relied upon for any purpose and do not form any part of any agreement. No liability is taken for any error, omission or misstatement. A party must rely upon its own inspection(s). Powered by www.Propertybox.co

- NO FORWARD CHAIN
- GARAGE
- FITED KITCHEN
- GOOD NEIGHBOURHOOD
- CLOSE TO BEACH
- 3 BEDROOM SEMI-DETACHED HOUSE
- FRONT AND BACK GARDEN
- FAMILY BATHROOM
- CLOSE TO FOOTPATH IN WOODLANDS
- CALL TO BOOK A VIEWING TODAY

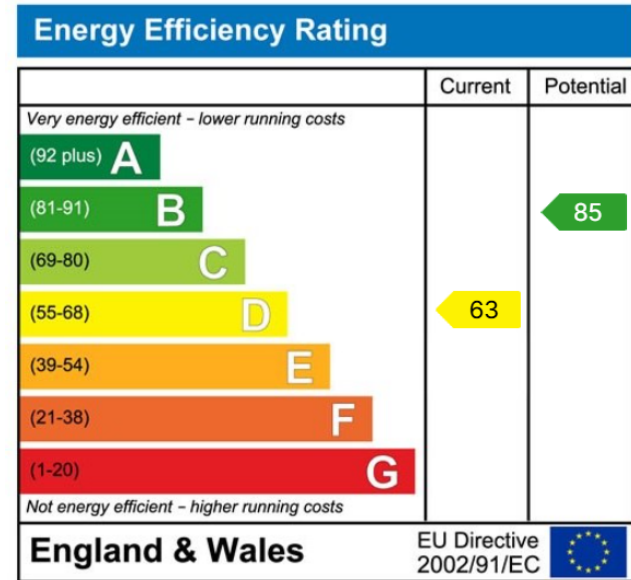

[www.enfields-southampton.co.uk](http://www.enfields-southampton.co.uk)



It is Enfields policy to respect any sole agency currently in force and we would not be able to commence marketing until this has expired or been terminated. If you fail to terminate any previous agreement you could be liable for two sets of fees. Enfields Hythe is a trading name of YTF LTD Registered office: 345 Shirley Road, Southampton, Hampshire, England, SO15 3JD. Company Registration No: 10459987. VAT Registration No: 281 2975 81.

Enfields Lettings - Embley Management LTD T/A Enfields. Registered Address: 345 Shirley Road, Southampton, Hampshire, England, SO15 3JD. Company Registration No: 14847604. VAT Registration No: 439 8546 45.

